

Secoroc Rotary Products

Blasthole TCI Bits

9" F6

Adding value through performance

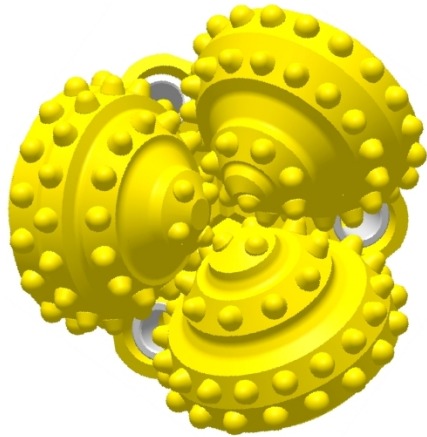

• Cutting Structure

Blunt conical inserts on gage and conical inserts on inner rows for durability and sustained penetration rates.

Designed for medium/hard formations such as hard limestone, hard shale, gold formations, medium-hard copper ores, dolomite and quartzite.

• Shirrtail Protection

Enhanced and Full

• Application

24,000 – 44,000 PSI / 165 – 303 MPa

Product Specifications:

IADC Code:	6-3-2
Bearing Type:	Roller – Ball – Roller /Air Cooled
Circulation Type:	Jet Air
Cutting Structure:	Tungsten Carbide Inserts
-Inner and Nose Rows	- Conical (86 Inserts)
- Gage Rows	- Blunt conical (52 Inserts)
-Gage Bevel Protection	- Flat (52 Inserts)
Lug/Shirrtail Protection:	Full Enhanced / Hardmetal with Inserts
Pin Connection:	4 1/2" API Regular
Metric Bit Diameter:	229 mm
Product Weight:	92.61 lbs / 42 kgs
Product Number/Code:	93001025 / 117-3229-63-FB-CY-02

Operating Suggestions:

Weight on Bit:	40,500 – 67,500 lbs
Rotary Speed:	70 to 120 RPM
Air Back Pressure:	35 psi, minimum

Actual drilling parameters must be determined for specific applications.

Atlas Copco Secoroc AB
Box 521, SE-737 25 Fagersta, Sweden
Phone: +46 223 461 00
E-mail: secoroc@se.atlascopco.com
www.atlascopco.com

